

## Disassembly

### 1. Fuse Replacement

- Remove two (2) 03923 cover mounting screws and 03924 motor cover Assy. (Figure 1).
- The fuse is now readily accessible for checking or changing.

### 2. Switch Removal

- Disconnect lead wires from power source (Figure 1).
- Remove two (2) 03923 cover mounting screws and 03924 motor cover Assy. (Figure 1).
- Remove switch retaining nut and remove wires from switch terminals.

### 3. Pump Removal

- Complete steps 2A and 2B above.
- Completely evacuate unit.
- Remove cover and bowl assembly screws (two (2) 03979 in rear from top side and two (2) 03943 in front from bottom side) and remove 03912 cover and bowl assembly (Figure 1).
- Remove four (4) 03925 pump mounting screws (Figure 1).
- Disconnect 03946 flush tube from pump outlet (Figure 1).
- Remove 03950 pump assembly (Figure 1).

### 4. Slide-Ez Valve Removal

- Disconnect lead wires from power source (Figure 1).
- Completely evacuate unit.  
Note: If you have an 03920 extension handle unit, cotter pin and extension handle must be removed at this point (Figure 2).
- Remove two (2) 03915 moulding mounting screws and remove two (2) base moldings (Figure 1).
- Remove slides by catching tabs with a hooked instrument and pulling forward.
- Lift Electra Magic from closet flange and invert unit.
- Remove four (4) 01663 screws and remove valve (Figure 2).

### 5. Sump Removal

- Complete steps 4A through 4D above.
- Remove flexible hose from sump and invert unit.
- Remove (4) 01663 screws and remove sump. (Figure 3).



Specially formulated by Thetford.

### All chemicals are not created equal.

#### Aqua Kem® Holding Tank Deodorant

- Fresh pleasing odor • Starts working instantly • Lasts longer • Compatible with all sanitation systems
- Liquid concentrate • Biodegradable • Non-corrosive • Septic tank safe • Child-resistant cap • 8-oz. and 32-oz. bottles.

#### Aqua Soft® Toilet Tissue.

- Soft snowy white tissue • Flushes easily from bowl . . . disintegrates rapidly in holding tanks • Helps prevent messy clogs • Recommended for portable and fixed sanitation systems • Uniquely packaged in reusable drawstring ditty bag • Four rolls per package.

**Aqua K-7®** cleans and polishes seven surfaces: plastic, vinyl, wood, leather, metal, fiberglass—even Formica™. Just squirt it on, wipe it off and watch it shine. Gives newness to your boat, camper, RV—plus many household items.

**Aqua Bowl® Cleaner.** Don't waste your precious vacation cleaning! In just 15 scrub-free minutes, a capful of Aqua Bowl leaves the toilet bowl clean and fresh. Nonabrasive soft scour. Freshens and cleans portable holding tanks for reuse and storage. Harmless to plastic parts, mechanical parts and seals. And use it at home. It's perfect for porcelain bowls, too.

Specially formulated by Thetford.

**THETFORD**  
For the love of all outdoors

The water miser.  
It's Electra Magic®



**Thetford Electra Magic®: whisper-quiet and clog free.** With Electra Magic, Thetford has revolutionized the recirculating toilet. You get all the space and water-saving advantages of recirculation . . . with none of the disadvantages.

Thetford's Electra Magic Recirculating Toilet System is a 100% self-contained sanitation system which requires no pressure water connection or holding tank installation (an optional holding tank may be installed to increase total capacity). The Electra Magic is operated by a simple 12 Volt D.C. hookup.

Thetford's unique dual filtration system puts an end to unpleasant clogging. The exclusive filter cone assures that only filtered fluid is delivered to the recirculating pump.

On the front of the Electra Magic is the Prismagic Level Indicator (another Thetford exclusive) which shows at a glance the content level of the recirculating tank. It also shows you the correct charge level and exactly when to evacuate the toilet.

Electra Magic's patented Slide-EZ Valve design assures leakproof performance. And it's backed by quality control testing of every unit.

**Electra Magic. Whisper-quiet and clog-free.**



**FIGURE 1**

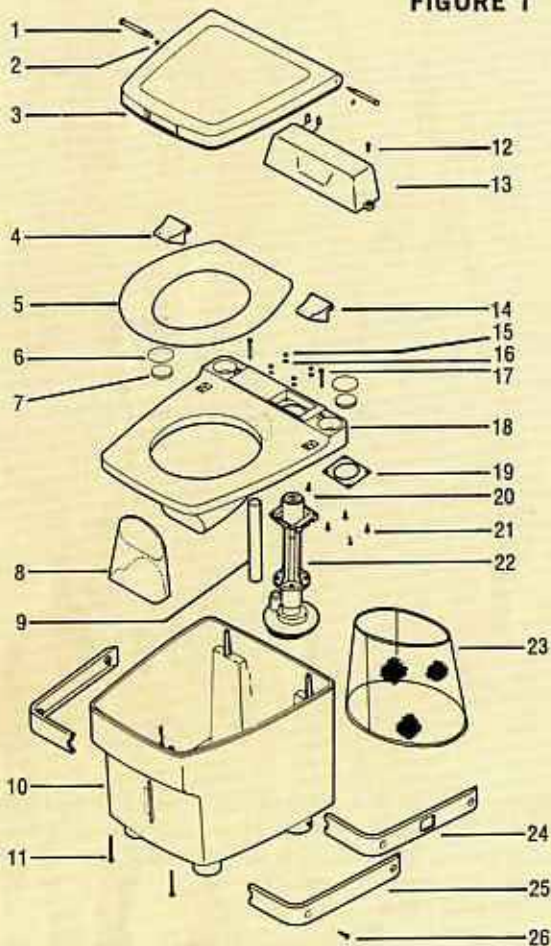

Key Part No. No.	Description
1	03921 Hinge Pin (2)
2	03922 Retaining Ring (2)
3	03916 Seat Cover Assy.
4	03953 Hinge-Left
5	03904 Seat and Bumper Assy.
6	03936 Cap (2)
7	05656 Splash Guard (2)
8	03984 Vinyl Skirt Assy.
9	03946 Inlet Tube
10	03929 Main Housing Assy
11	03943 Screw-Front (2)
12	03923 Screw-Cover Mtg. (2)
13	03924 Motor Cover Assy.
14	03905 Hinge-Right

Key Part No. No.	Description
15	03927 Nut (4)
16	03990 Lock Washer (4)
17	03979 Screw-Rear (2)
18	03912 Cover and Bowl Assy.
19	03928 Gasket-Pump Mtg.
20	03937 Screw-Hinge Mtg. (2)
21	03925 Screw-Pump Mtg. (4)
22	03950 Pump Assy.
23	05534 Filter Cone
24	05048 Base Molding*
25	05248 Base Molding (2)
26	03915 Screw-Molding Mtg. (2)

**FIGURE 2\* WITH VALVE**

Model 03900 and 03920 Electra Magic includes valve for direct termination to holding tank.

**Key Part**

No. No.	Description
1	08636 Mtg. Bracket (2)
	08637 Slide (2)
2	03911 Handle
3	03913 Retaining Ring
4	01663 Screw (4)
5	03632 Slide-Ez Valve (2X Slide-Ez Valve)*
6	02125 Flange Seal
7	08638 Nut (2)
8	03918 Closet Stud (2)



**FIGURE 3† WITH SUMP**

Model 03930 Electra Magic includes sump for pump-out evacuation for dockside discharge.

**Key Part**

No. No.	Description
1	03940 Sump Asm.
2	01663 Screw (4)
3	05048 Closet Screw Pkg.
4	08636 Mtg. Bracket (2)
	08637 Slide (2)

\* These parts pertain to 03920 Extension Handle units.  
† These parts pertain to 03930 Marine units.

**Dimensions**

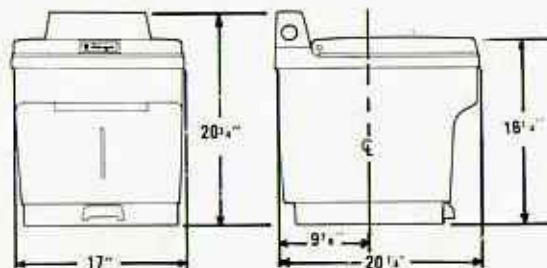

**Accessories**



REFILL PACKAGE  
03947



VENT KIT  
05223



DOCKSIDE DISCHARGE  
05222

**Installation**

**RV INSTALLATION INSTRUCTIONS**

1. Install the two closet bolts in closet flange.
2. While holding bolt up so that head touches underside of closet flange, install one nylon nut on each bolt and screw nuts down until they touch top of gauge (if gauge is misplaced, bottom surface of nuts should be .90 in. above floor).



3. Turn Electra Magic upside-down and install closet flange seal on Slide-Ez-Valve with flat side against toilet.
4. Make sure white fork-shaped slides are in forward position.

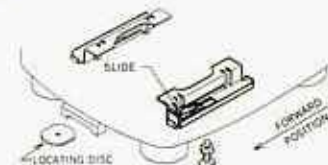

5. Place unit on closet flange and locate position for plastic locator disc by tracing around one of the front legs. Drill 5/32 dia. hole in floor and fasten disc to floor with flat sides oriented as shown. Use #10 screw provided. Important. This disc prevents toilet from moving on floor.
6. Lower Electra Magic onto closet flange until nuts on closet bolts go through rectangular holes in metal brackets, seal rests on closet flange, and leg locates over locating disc.
7. Insert a screwdriver or other long rigid instrument under toilet and with a sharp blow drive each slide back until it slides under nut and snaps into position.



8. If slides cannot be driven by one or two blows, remove toilet and adjust each nylon nut one-half turn upward and repeat procedure from Step 4.
9. If the toilet wobbles excessively, remove slides by catching tabs with a hooked instrument and pulling forward, as shown below. Lift toilet off, adjust each nylon nut one-half turn downward and repeat procedure from step 4.



10. The unit should now be firmly anchored to the floor.



**MULTIPLE POSITIONS USING EXTENSION HANDLE VALVE (MODEL 3920)**

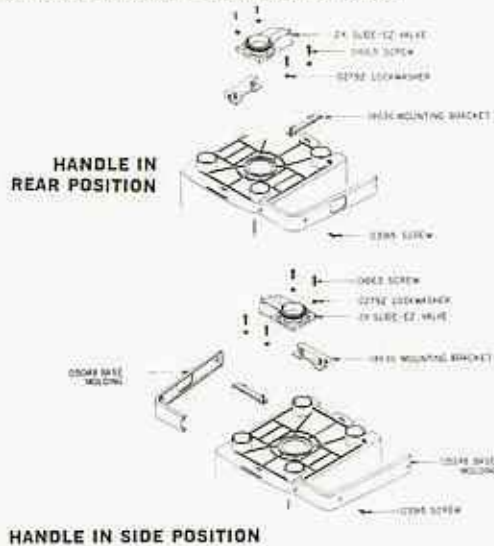

5. Install one nylon nut on each bolt and screw nut down until it touches top of gauge (if gauge is misplaced, bottom surface of nut should be .90 in. above floor).

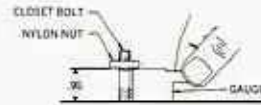

6. Lower Electra Magic over bolts until nylon nuts go through rectangular holes in metal brackets and the unit rests on its feet.  
7. Insert a screwdriver or other long rigid instrument under the toilet and with a sharp blow drive each slide back until it slides under nut, and snaps into position.

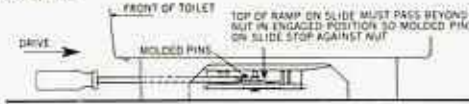

8. If slides cannot be driven by one or two blows, remove toilet and adjust each nylon nut one-half turn upward and repeat procedure from Step 6.  
9. If the toilet wobbles excessively, remove slides by catching tabs with a hooked instrument and pulling forward, as shown below. Lift toilet off, adjust each nylon nut one-half turn downward and repeat procedure from Step 6.



10. The unit should now be firmly anchored to the floor.

**LIMITED 1 YEAR WARRANTY**

You have just purchased one of the finest recreational products made. It is warranted subject to the following terms and conditions:

1. Thetford products are warranted to the original owner for a period of one (1) year from the date of purchase. The warranty may provide for repair, exchange of parts or replacement of defective unit as necessary, including labor, upon the condition that the necessary repairs, etc. are performed through a Thetford Certified Service Center.
2. Units returned under this warranty will be inspected. Damages which in Thetford's judgment occur from misuse, negligence, accident or any other unreasonable use shall invalidate this warranty. In addition where the product has been tampered with or altered in any way or if the serial number or date of manufacture stamp has been effaced, altered or removed, this warranty is void.
3. Should an owner possess a unit believed to be defective he must insure that said unit or easily removable part is returned to a Thetford Certified Service Center for inspection. The Service Center will determine whether or not the warranty claim is valid. If the Thetford Certified Service Center finds the unit or part defective and is a proper warranty claim, repairs will be made free of charge and returned prepaid to the owner. Your Thetford unit or part may be returned to Thetford Corporation, P. O. Box 1285, Ann Arbor, Michigan, in lieu of returning such to a Thetford Certified Service Center.
4. No other express warranty is given and no person or representative is authorized to make any warranties or assume any liability by words or action which shall constitute a warranty other than what is contained herein.

**MARINE INSTALLATION INSTRUCTIONS**

**CAUTION:** Toilet is not explosion proof, and must not be located in an area where an explosive atmosphere exists, such as gasoline fumes, etc.

1. Install white fork-shaped slides on brackets. Make one right bracket ass'y and one left bracket ass'y. Right bracket ass'y shown.

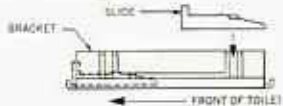

2. Mount bracket ass'ys and sump to bottom of toilet with four screws. As shown in Marine installation drawings brackets are sandwiched between sump and toilet.

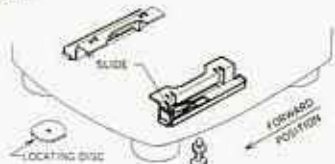

3. Locate toilet position with template and install bolts in floor by drilling (7/32 dia.) hole in floor, putting acorn nut on bolts, and driving bolts into floor with wrench. Remove acorn nuts.

4. Also using template, locate position for plastic locator disc. Drill 5/32 dia. hole in floor and fasten disc to floor with flat sides oriented as shown. Use #10 screw provided. Important. This disc prevents toilet from moving on floor.

**MULTIPLE POSITIONS USING SUMP DISCHARGE (MODEL 3930)**

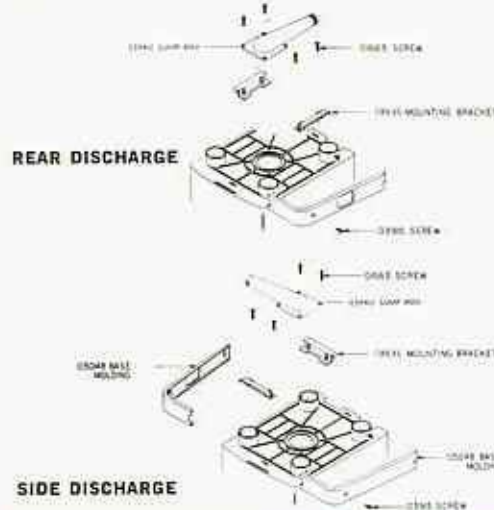

MODEL NO. \_\_\_\_\_ COLOR \_\_\_\_\_

WHY DID YOU CHOOSE A THETFORD PRODUCT? \_\_\_\_\_

DEALER'S NAME \_\_\_\_\_

DEALER'S ADDRESS \_\_\_\_\_

DATE OF PURCHASE \_\_\_\_\_

TYPE OF USE

\_\_\_\_\_  \_\_\_\_\_

\_\_\_\_\_  \_\_\_\_\_

\_\_\_\_\_  \_\_\_\_\_

OTHER (Specify) \_\_\_\_\_

MAKE OF RECREATIONAL VEHICLE OR BOAT \_\_\_\_\_

SIGNED \_\_\_\_\_



# The non-stop way to evacuate holding tanks. Thermasan waste destruction systems.

Free yourself from routine stops to dump your RV holding tank. Let Thermasan destroy waste as you drive. All you do is flip a handy switch. Thermasan does the rest, automatically.

Holding tank wastes are metered into the exhaust system, where super-hot exhaust gases reduce wastes to an invisible, bacteria-free condition. Special speed and heat sensors disallow incomplete waste destruction, to meet National Sanitation Foundation requirements.

Thermasan systems permit tailoring an installation for nearly any Motor Home. Installed by manufacturers of all leading Motor Homes. Or can be installed on your coach by your Thermasan dealer.

**Thermasan 600 system:** For Motor Homes with one holding tank containing both waste water and toilet waste. Disposal rate: about 1 gallon per 15 miles of highway driving.

**Thermasan 2-500 system:** For Motor Homes with two holding tanks, one for wash water and one for toilet waste. Disposal rate: about 1 gallon (1/2 gallon per tank) per 15 miles of highway driving.



Just a flip of the switch and Thermasan goes into action, incinerating holding tank wastes as you drive.



Thermasan B and BL models are designed for motor homes, van conversions, custom coaches—wherever holding tank and engine are attached to the same chassis.

Clip & mail to: Thetford Corp., P.O. Box 1285  
Ann Arbor, Mich. 48106

## WARRANTY REGISTRATION CARD

**THETFORD** 313-769-6000  
**ELECTRA MAGIC®**

- I would like complete information on Thermasan
- I have tried Aqua-Kem Concentrate deodorant in my holding tank.
- Yes No

Name \_\_\_\_\_

Address \_\_\_\_\_

City \_\_\_\_\_

State \_\_\_\_\_ Zip \_\_\_\_\_

## Electrical Hookup

Connect directly to 12 volt DC Source as a separate circuit. Use minimum size #14 gauge wire. (Black wire to positive (hot), white to negative (ground)).

**Important**—Be sure polarity of power supply has been properly determined and correctly connected to lead wires before operating.

## Operating Instructions

### 1. Initial Flush Charge

- Pour approximately three gallons of water in bowl (until water reaches the charge level (C) on indicator lens).
- Add eight ounces of Aqua Kem® Concentrate holding tank deodorant.

### 2. To Flush

Depress flush button.

NOTE: Do not depress button when unit is empty.

### 3. To Evacuate

The Electra Magic Models 03900 and 03920 are fitted with a termination valve on the bottom of the unit. Depending on the installation one of the following procedures should be followed:

- Without holding tank: attach discharge hose to outlet and open termination valve.
- With holding tank: open termination valve, this dumps contents of unit into the holding tank.

### 4. Evacuation Prior to Temporary Storage

- Completely evacuate unit as described above.
- Refill unit to bottom of bowl with fresh water.
- Add a cup of Aqua Bowl® Cleaner.
- Cycle three times, by depressing flush button for 10 seconds each.
- Let stand a few minutes for cleaning action.
- Completely evacuate unit again.
- The unit is now ready for storage.

### 5. Winterizing

- For winter storage, evacuate unit as described in Step 4.
- For winter use, replace one half of the charge water with an approved plastic pipe anti-freeze.

## Service and Parts

See warranty section for service information.

Refer to your local Thetford dealer for parts and service.

If it becomes necessary to send parts to a Thetford Certified Service Center for warranty consideration or to contact the factory, please include the following information:

- Your name and address.
- The product name, model, serial number, and color.
- The type of recreational vehicle or boat (Brand Name and year) on which the product is used.
- The reason for return.
- Proof of date of purchase.

## Trouble-shooting

### 1. Symptom: Toilet wobbles.

**Cause:**

- Closet flange too high.
- Mounting surface uneven.

**Cure:**

- & B. Check closet flange height by laying straight edge across flange and measuring gap between straight edge and floor at four (4) leg locations (1/4 to 7/16 inch is recommended).

### 2. Symptom: Flushing action is weak or noisy.

**Cause:**

- Pump is running backwards (reversed wiring polarity).
- Cycling unit without enough charge water.
- Pump damaged by continuous dry operation.

**Cure:**

- The black wire is positive (hot) and the white wire is negative (ground).
- Charge to proper level (three gallons). Fill to charge level (c) on indicator lens.
- Replace 03950 pump assembly (see fig. 1.)

INSTRUCTIONS--USE OF 03947 REFILL KIT

A. INITIAL FLUSH CHARGE

1. Turn wall valve on to start water flow. (This will create a turbulent sound of running water inside of Electra Magic.
2. Listen for change in sound of running water. (When the unit has sufficient water for initial flush charge, the turbulent sound will cease.) Then turn wall valve off. Water should be at the charge level (c) on indicator lens.
3. Pour one (1) eight-ounce bottle of Aqua Kem Concentrate in bowl and flush to mix.
4. The unit is now ready for use.

B. RINSING PRIOR TO CONTINUING USE

1. Completely evacuate unit.
2. Turn refill on for a few seconds and then shut off.
3. Evacuate unit again.
4. For continued use, recharge unit as described in Item A.

C. RINSING PRIOR TO TEMPORARY STORAGE

1. Completely evacuate unit.
2. Turn refill on for a few seconds and then shut off.
3. Evacuate unit again.
4. Turn refill on and fill unit to within three inches of bowl top--then shut refill off.
5. Add two inches (from the bottle) of Aqua Bowl Cleaner.
6. Cycle unit three (3) times.
7. Let stand for a few minutes for cleaning action.
8. Make final evacuation.
9. The unit is now ready for storage.

D. WINTERIZING

1. Winterize the Electra Magic as described in Owner's Manual.
2. Complete by performing one fo the following procedures:
  - a. Drain all water lines as recommended by the trailer or boat manufacturer and leave spigots open.

OR

- b. Winterize fresh water system with an approved plastic pipe anti-freeze such as Aqua Thaw Recreational Anti-Freeze.

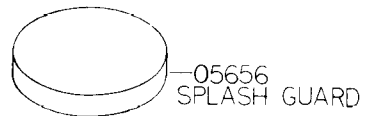
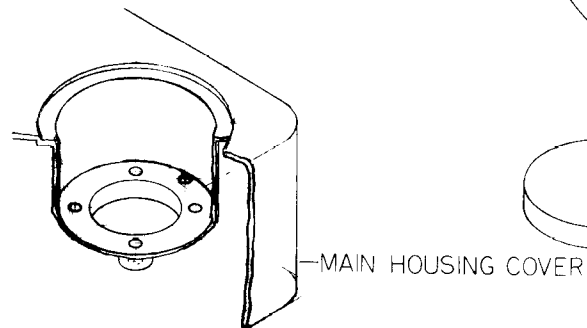
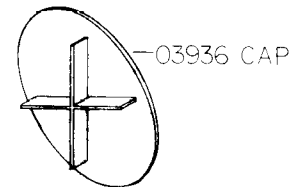
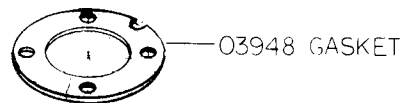
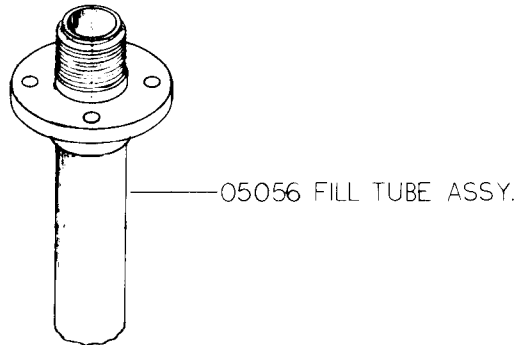
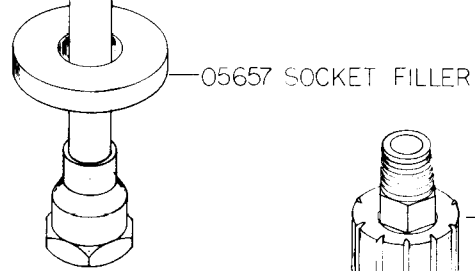
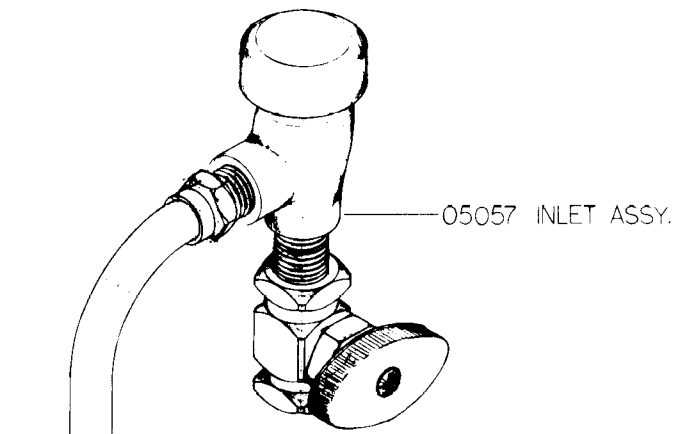

INSTRUCTIONS--INSTALLATION OF 03947 REFILL KIT

- A. Remove 03936 Cap and 05656 Splash Guard from the side of the Electra Magic Main Housing Cover on which the refill kit is to be installed.
- B. Assemble 05056 Fill Tube Assembly to 05057 Inlet Assembly, noting desired relationship between inlet and flange indexing pin.
- C. Put 03948 Gasket in place, aligning all five holes properly.
- D. Place fill tube and inlet assembly into the unit, making sure the locating pin goes into the proper hole in the Electra Magic unit, and mount with the screws provided.
- E. Tighten down screws.
- F. Stretch 05657 Socket Filler over hex body of 05057 Inlet Assembly and work socket filler down until it is flush with the top of main housing cover.
- G. Connect water supply to refill kit (05226 Garden Hose Adaptor (furnished) may be used as an option for filling with hose).